

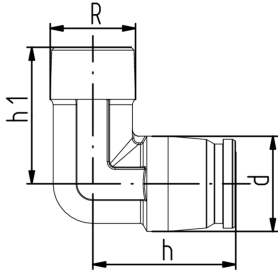

Transition elbow module male thread

* low lead



	d (mm)	R (inch)	Part No.	SP	weight (kg)	h (mm)	h1 (mm)
	16 - 20	½	762 101 051	10	0.071	30	34
	16 - 20	¾	762 101 052	10	0.076	30	35
	25 - 32	¾	762 101 099	2	0.189	45	43
	25 - 32	1	762 101 100	2	0.214	45	45
*	16 - 20	½	762 101 270	10	0.071	30	34
*	16 - 20	¾	762 101 271	10	0.076	30	35
*	25 - 32	¾	762 101 285	2	0.189	45	43
*	25 - 32	1	762 101 286	2	0.214	45	45

The technical data are not binding. They neither constitute expressly warranted characteristics nor guaranteed properties nor a guaranteed durability. They are subject to modification. Our General Terms of Sale apply.

Georg Fischer Piping Systems Ltd, Postfach, CH-8201 Schaffhausen/Switzerland

Phone +41 -(0)52-631 1111

e-mail: info.ps@georgfischer.com

Internet: <http://www.gfps.com>